

Floor Plan

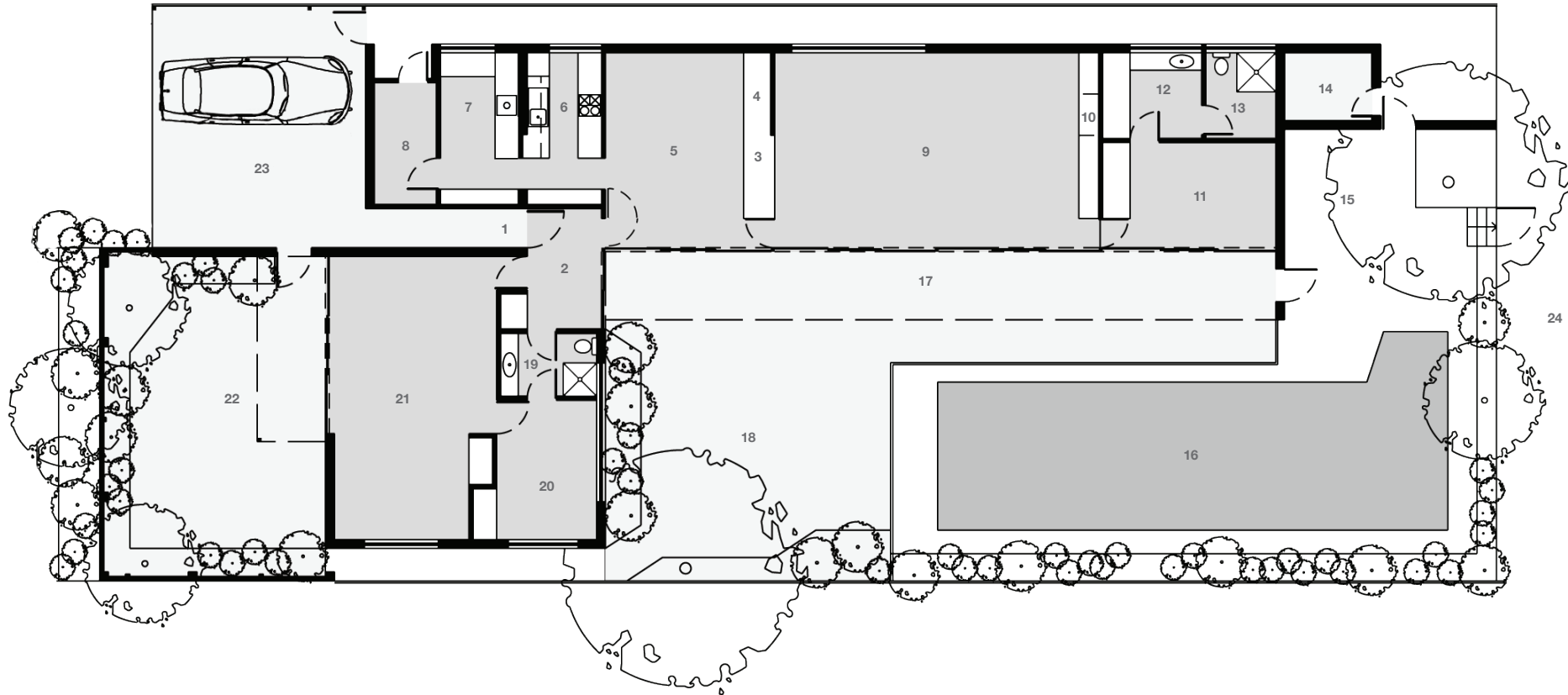

0 1 2 5m



Architect: Hall & Bowe
Helsham House
 8 First Avenue
 Willoughby East
 Sydney NSW 2068

Designed and built: 1974
Design Architect: Peter Hall
 Alts + Adds: Lewin Tzannes Architects, 1990
 3 Bedroom, 2 Bath, 2 Car
 Internal area (approx.) 172 sq m (1,851 sq ft)
 External terrace area (approx.) 137 sq m (1,475 sq ft)
 Land area (approx.) 1,075 sq m (11,571 sq ft)

1 Main Entry
2 Entrance Lobby
3 Servery
4 Study Nook
5 Family
6 Kitchen

7 Laundry
8 Storeroom
9 Dining & Living
10 Fireplace
11 Master Bedroom
12 Walk-In-Robe

13 Ensuite
14 External Storeroom
15 Swimming Pool Terrace
16 Swimming Pool
17 Covered Living Terrace
18 Dining Terrace

19 Bathroom
20 Bedroom [2]
21 Bedroom [3]
22 Bedroom Terrace
23 Carport
24 Tennis Court



PLEASE NOTE: WHILST MODERN HOUSE TAKES EVERY CARE IN THE PURSUIT OF ACCURACY, THE PLAN SHOWN IS FOR GENERAL GUIDANCE ONLY. ALL AREAS, MEASUREMENTS AND DISTANCES ARE APPROXIMATE AND NOT TO SCALE. MODERN HOUSE AND OUR VENDOR WILL ACCEPT NO LIABILITY FOR ITS ACCURACY. INTERESTED PARTIES ARE ADVISED TO MAKE THEIR OWN INDEPENDENT ENQUIRIES

WWW.MODERNHOUSE.CO THE SPECIALIST ESTATE AGENCY FOR ARCHITECT-DESIGNED RESIDENCES Email: sales@modernhouse.co Tel: **1300 814 768**

Site Plan

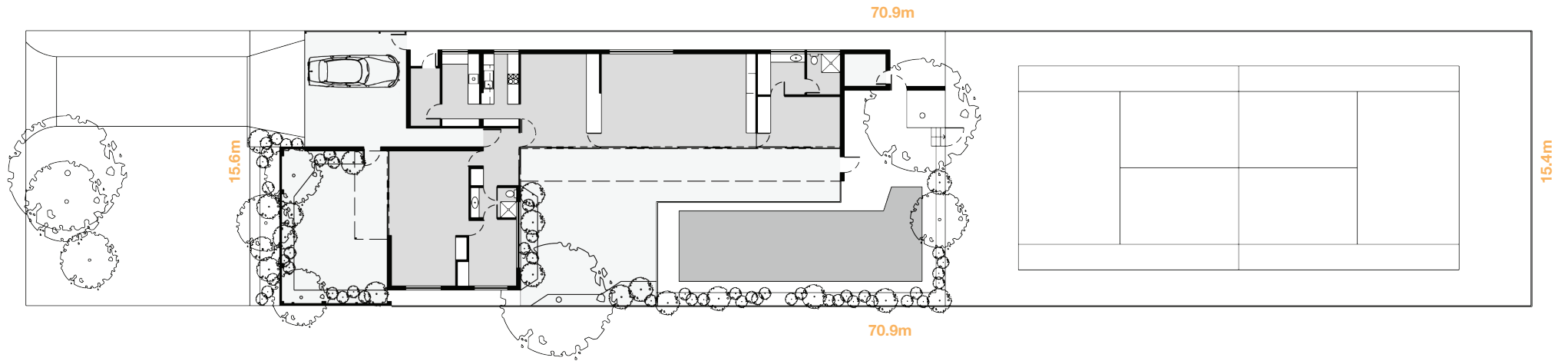

0 1 2 5m



Architect: Hall & Bowe
Helsham House
8 First Avenue
Willoughby East
Sydney NSW 2068

Designed and built: 1974
Design Architect: Peter Hall
Alts + Adds: Lewin Tzannes Architects, 1990
3 Bedroom, 2 Bath, 2 Car
Internal area (approx.) 172 sq m (1,851 sq ft)
External terrace area (approx.) 137 sq m (1,475 sq ft)
Land area (approx.) 1,075 sq m (11,571 sq ft)

