

# Floor Plan

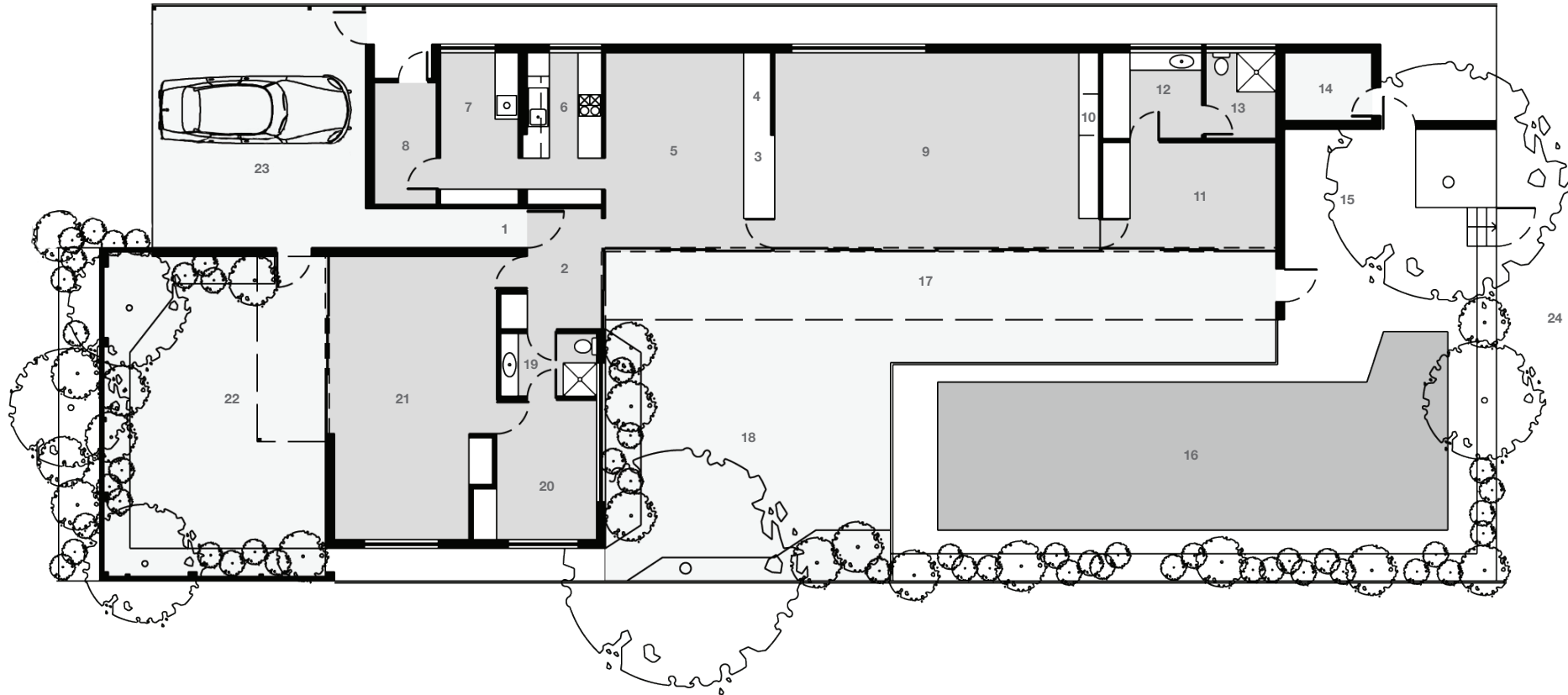

**Architect: Hall & Bowe**  
**Helsham House**  
 8 First Avenue  
 Willoughby East  
 Sydney NSW 2068

**Designed and built: 1974**  
**Design Architect: Peter Hall**  
 Alts + Adds: Lewin Tzannes Architects, 1990  
 3 Bedroom, 2 Bath, 2 Car  
 Internal area (approx.) 172 sq m (1,851 sq ft)  
 External terrace area (approx.) 137 sq m (1,475 sq ft)  
 Land area (approx.) 1,075 sq m (11,571 sq ft)

- 1 Main Entry
- 2 Entrance Lobby
- 3 Servery
- 4 Study Nook
- 5 Breakfast
- 6 Kitchen

- 7 Laundry
- 8 Storeroom
- 9 Dining & Living
- 10 Fireplace
- 11 Master Bedroom
- 12 Walk-In-Robe

- 13 Ensuite
- 14 External Storeroom
- 15 Swimming Pool Terrace
- 16 Swimming Pool
- 17 Covered Living Terrace
- 18 Dining Terrace

- 19 Bathroom
- 20 Bedroom [2]
- 21 Bedroom [3]
- 22 Bedroom Terrace
- 23 Carport
- 24 Tennis Court



# Site Plan

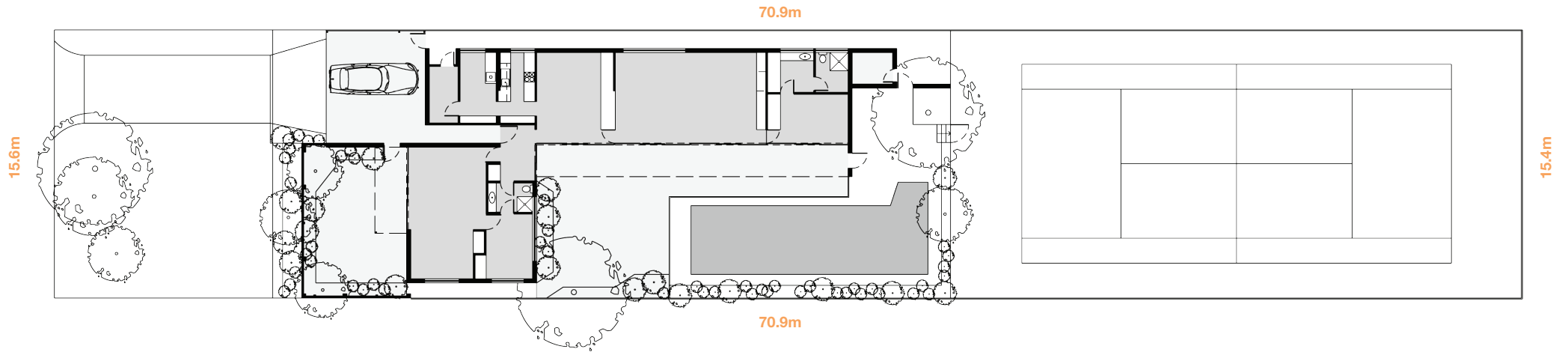

0 1 2 5m



**Architect: Hall & Bowe**  
**Helsham House**  
 8 First Avenue  
 Willoughby East  
 Sydney NSW 2068

**Designed and built: 1974**  
**Design Architect: Peter Hall**  
 Alts + Adds: Lewin Tzannes Architects, 1990  
 3 Bedroom, 2 Bath, 2 Car  
 Internal area (approx.) 172 sq m (1,851 sq ft)  
 External terrace area (approx.) 137 sq m (1,475 sq ft)  
 Land area (approx.) 1,075 sq m (11,571 sq ft)

- 1 Main Entry
- 2 Entrance Lobby
- 3 Servery
- 4 Study Nook
- 5 Breakfast
- 6 Kitchen
- 7 Laundry
- 8 Storeroom
- 9 Dining & Living
- 10 Fireplace
- 11 Master Bedroom
- 12 Walk-In-Robe

- 13 Ensuite
- 14 External Storeroom
- 15 Swimming Pool Terrace
- 16 Swimming Pool
- 17 Covered Living Terrace
- 18 Dining Terrace

- 19 Bathroom
- 20 Bedroom [2]
- 21 Bedroom [3]
- 22 Bedroom Terrace
- 23 Carport
- 24 Tennis Court

