

# Floor Plan

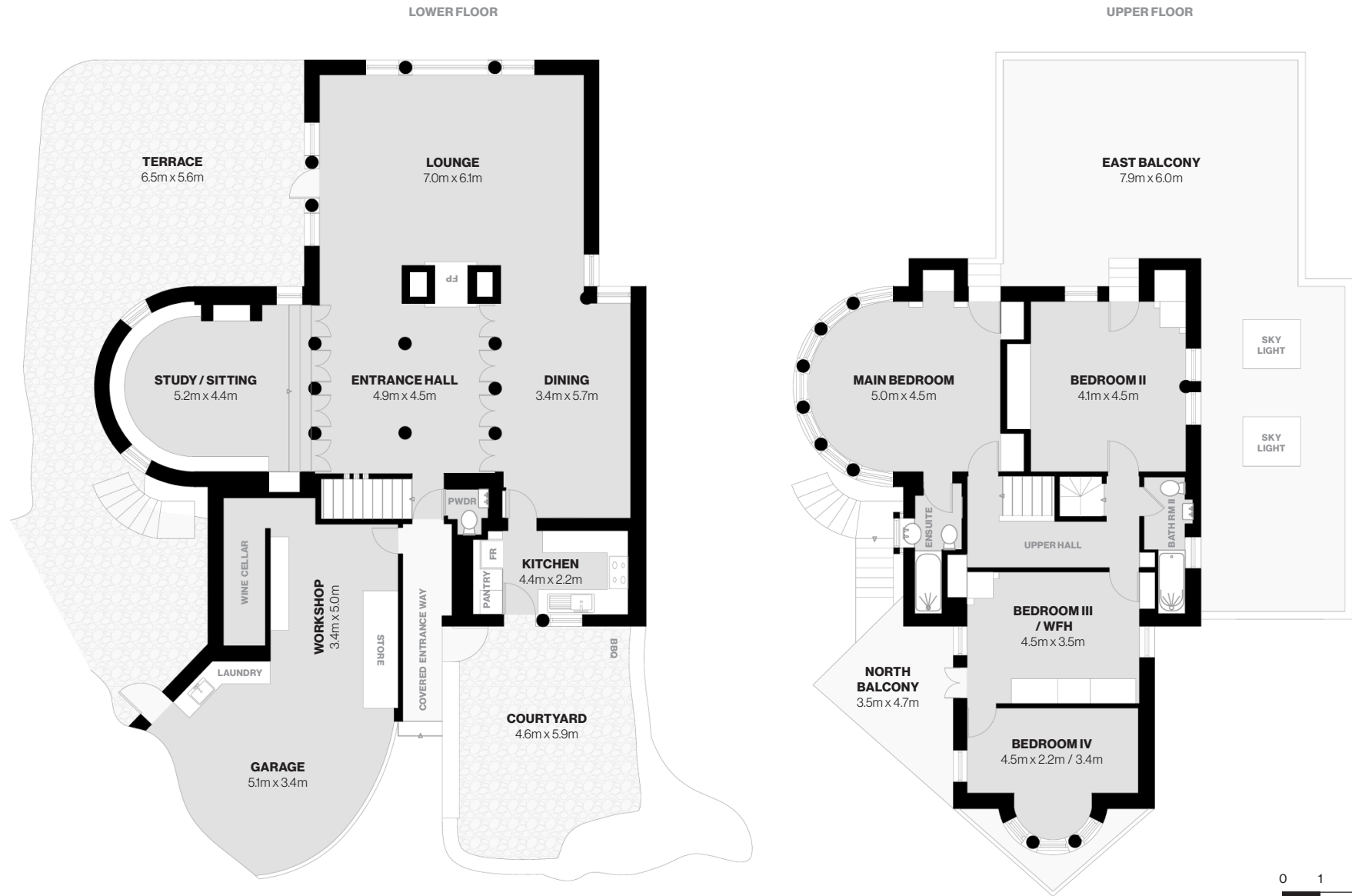

**Architect: Walter Burley Griffin**  
**The Fishwick house**  
 Castlecrag  
 Sydney NSW 2068

**Designed: 1929**  
**Build Completed: c.1931**  
 4 bed, 2 bath, 1 guest w/c, multiple living  
 1 car (garaged)  
 Separate accommodation option Bd 3&4

**Conservation Architect: Tropman & Tropman Architects**  
**Restoration: 1996 -1998**  
 Willoughby Local Environmental Plan: #1995  
 Heritage Act - State Heritage Register: #01751  
 Register of the National Estate (Non-statutory archive): #101557

**Total Living (approx.) 295 sq m (3,175 sq ft)**  
**Land area (approx.) 809.3 sq m (8,711 sq ft)**  
 Internal living area (approx.) 200 sq m (2,153 sq ft)  
 Total internal area (approx.) 235 sq m (2,530 sq ft)  
 External living area (approx.) 95 sq m (1,022 sq ft)

