

**Architect: Peter Stutchbury Architecture**  
**Vista House**  
 1929 & 1977 Paynes Crossing Road  
 Paynes Crossing NSW 2325

**Design Architect: Peter Stutchbury**  
**Designed & Built: 2010 – 2017**  
 Structural Engineer: Northrop  
 Builder: Rock Solid Construction  
 Landscaping: Michael Cooke

**3 bed, 1.5 bath, study, 3 car**  
**Land: 48.56 ha (119.85 ac)**  
 Internal Living: 124 sqm  
 External Living: 162 sqm (terraces x3)  
 Total: 286 sqm (carport & store not inc.)

**1** Carport 8.5 x 8.5m  
**2** Entry / Kitchen Terrace 6.2 x 4.8m  
**3** Kitchen / Dining 7.6 x 4.6m  
**4** Living / 10 Swag Courtyard 13.8 x 7.9m  
**5** Living / Bedroom I (Guest) 5.7 x 3.6m  
**6** Laundry 1.7 x 3.3m

**7** Wet Room 2.8 x 3.8m  
**8** Bath Terrace 3.9 x 4.4m/6.1m  
**9** Bedroom II 4.3 x 3.8m  
**10** Study 4.1 x 4.4m  
**11** Bedroom III 4.3 x 3.8m  
**12** Store (& Plant Room) 8.5 x 1.6m

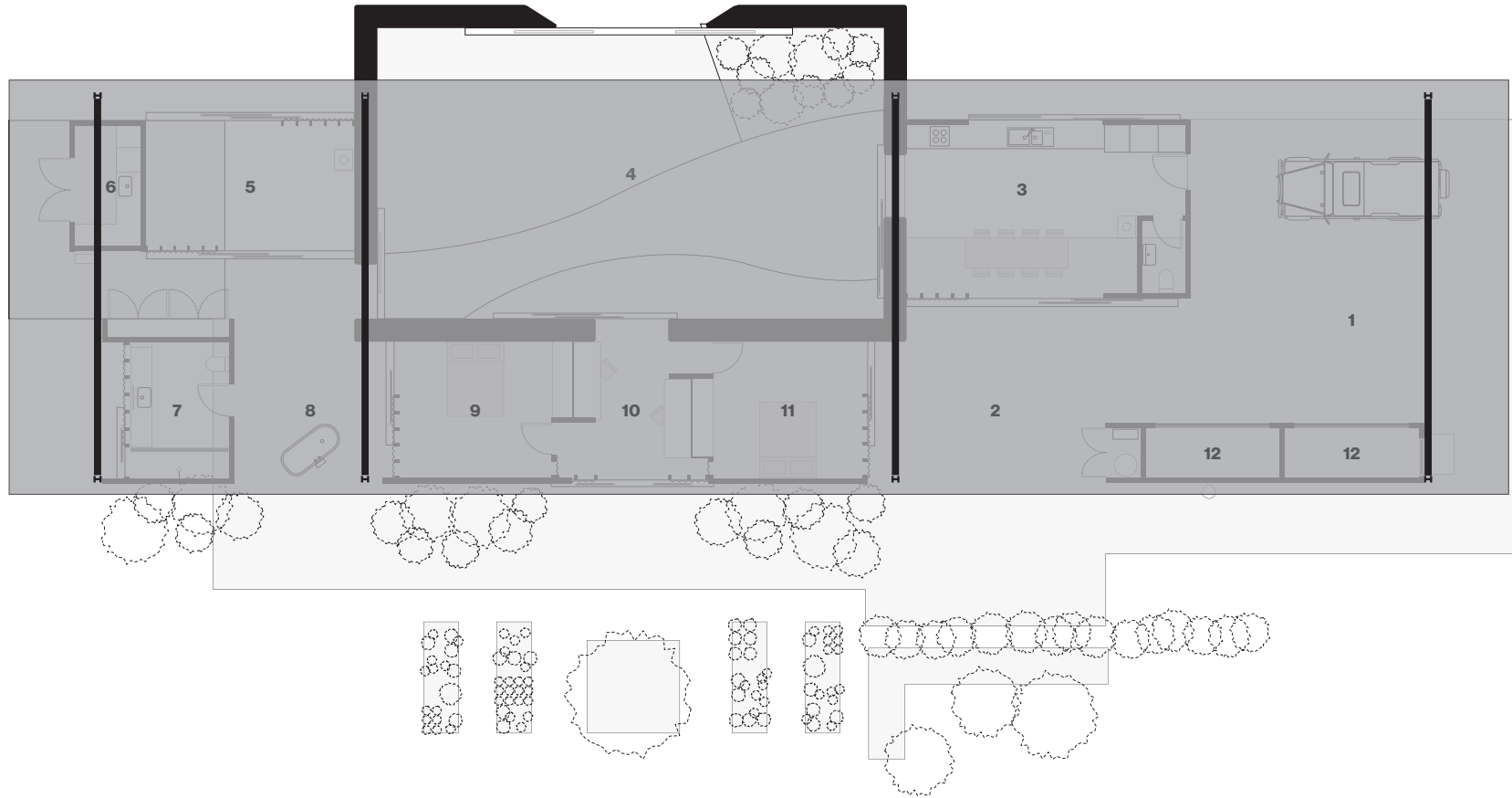

0 1 2 5m



**Architect: Peter Stutchbury Architecture**  
**Vista House**

1929 & 1977 Paynes Crossing Road  
Paynes Crossing NSW 2325

**Design Architect: Peter Stutchbury**

**Designed & Built: 2010 – 2017**

Structural Engineer: Northrop  
Builder: Rock Solid Construction  
Landscaping: Michael Cooke

**3 bed, 1.5 bath, study, 3 car**

**Land: 48.56 ha (119.85 ac)**

Internal Living: 124 sqm  
External Living: 162 sqm (terraces x3)  
Total: 286 sqm (carport & store not inc.)

- 1** Carport 8.5 x 8.5m
- 2** Entry / Kitchen Terrace 6.2 x 4.8m
- 3** Kitchen / Dining 7.6 x 4.6m
- 4** Living / 10 Swag Courtyard 13.8 x 7.9m
- 5** Living / Bedroom I (Guest) 5.7 x 3.6m
- 6** Laundry 1.7 x 3.3m

- 7** Wet Room 2.8 x 3.8m
- 8** Bath Terrace 3.9 x 4.4m/6.1m
- 9** Bedroom II 4.3 x 3.8m
- 10** Study 4.1 x 4.4m
- 11** Bedroom III 4.3 x 3.8m
- 12** Store (& Plant Room) 8.5 x 1.6m

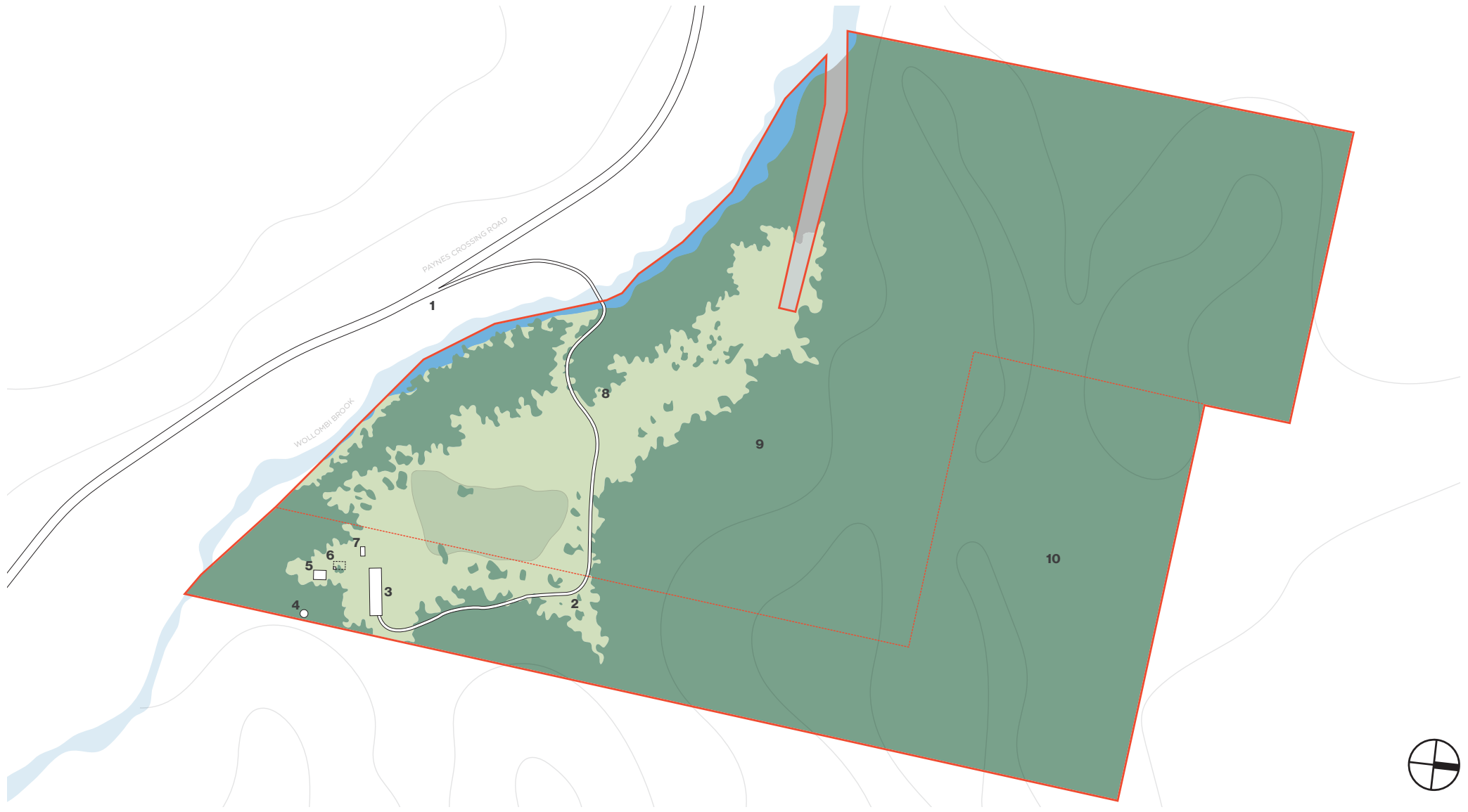

**Architect: Peter Stutchbury Architecture**  
**Vista House**  
 1929 & 1977 Paynes Crossing Road  
 Paynes Crossing NSW 2325

**Design Architect: Peter Stutchbury**  
**Designed & Built: 2010 – 2017**  
 Structural Engineer: Northrop  
 Builder: Rock Solid Construction  
 Landscaping: Michael Cooke

**3 bed, 1.5 bath, study, 3 car**  
**Land: 48.56 ha (119.85 ac)**  
 Internal Living: 124 sqm  
 External Living: 162 sqm (terraces x3)  
 Total: 286 sqm (carport & store not inc.)

- 1 Entry Gate
- 2 Settler's Orchard
- 3 Vista House
- 4 Main Water Tank (60,000L)
- 5 Main Store/Machinery Shed
- 6 Chicken Enclosure

- 7 Solar Array
- 8 'The Cabin'
- 9 #1929 – Lot 31, 61 – 32.37 hectares
- 10 #1977 – Lot 56 – 16.19 hectares