

**Architect: Peter Stutchbury Architecture**  
**Vista House**  
 1977 & 1929 Paynes Crossing Road  
 Paynes Crossing NSW 2325

**Design Architect: Peter Stutchbury**  
**Designed & Built: 2012–2017**  
 Structural Engineer: Northrop  
 Builder: Rock Solid Construction  
 Landscaping: Michael Cooke

**3 bed, 1.5 bath, study, 3 car**  
**Land: 48.56 ha (119.85 ac)**  
 Internal Living: 124 sqm  
 External Living: 162 sqm (terraces x3)  
 Total: 286 sqm (carport & store not inc.)

- 1 Carport, 8.5m x 8.5m
- 2 Entry / Kitchen Terrace, 6.2m x 4.8m
- 3 Kitchen / Dining, 7.6m x 4.6m
- 4 Living / 10 Swag Courtyard, 13.8m x 7.9m
- 5 Living / Bedroom 1 (Guest), 5.7m x 3.6m
- 6 Laundry, 1.7m x 3.3m

- 7 Wet Room, 2.8m x 3.8m
- 8 Bath Terrace, 3.9m x 4.4m/6.1m
- 9 Bedroom 2, 4.3m x 3.8m
- 10 Study, 4.1m x 4.4m
- 11 Bedroom 3, 4.3m x 3.8m
- 12 Plant Room & Store, 8.5m x 1.6m

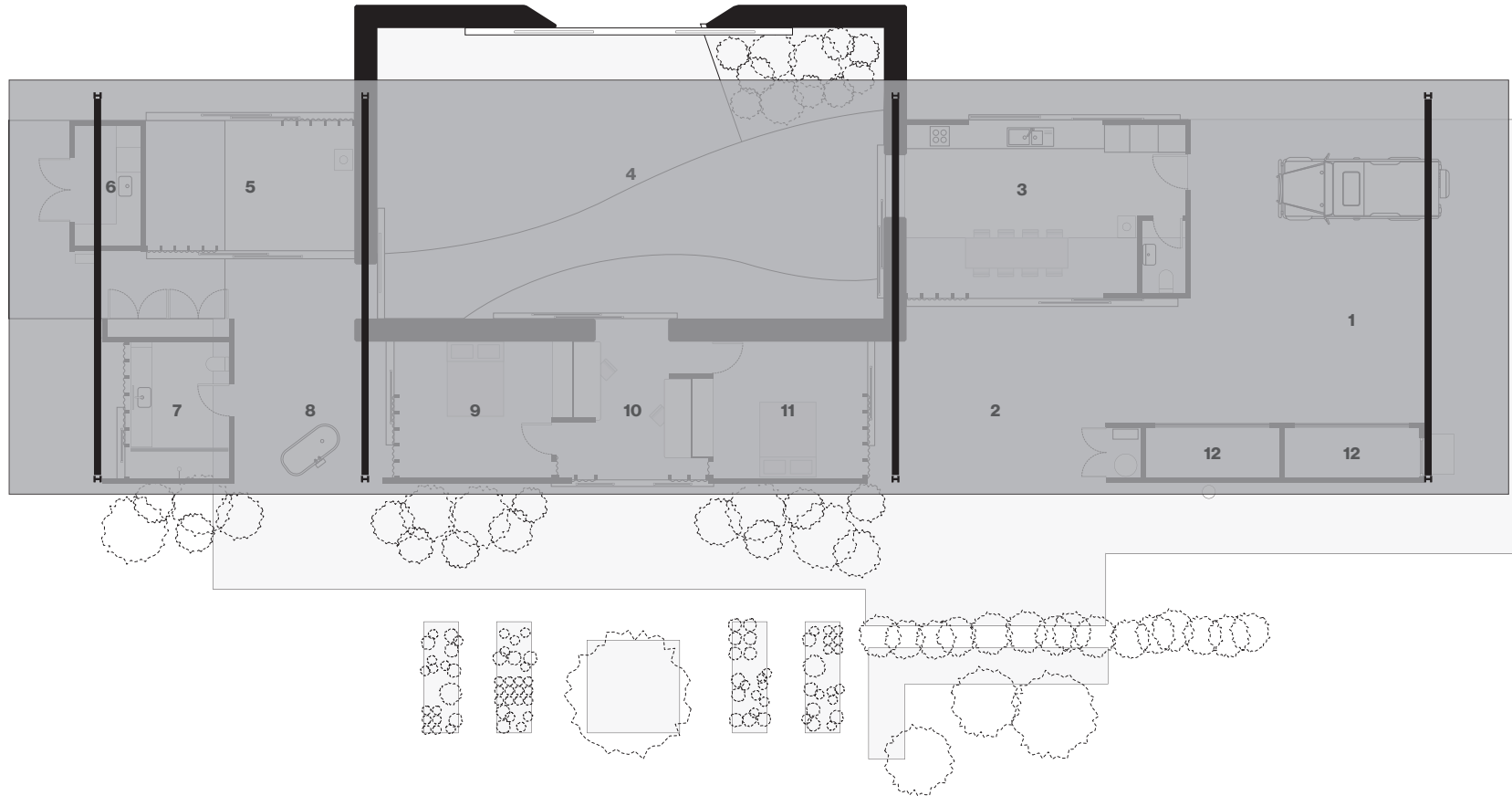

0 1 2 5m



**Architect: Peter Stutchbury Architecture  
Vista House**

1977 & 1929 Paynes Crossing Road  
Paynes Crossing NSW 2325

**Design Architect: Peter Stutchbury**

**Designed & Built: 2012–2017**

Structural Engineer: Northrop  
Builder: Rock Solid Construction  
Landscaping: Michael Cooke

**3 bed, 1.5 bath, study, 3 car**

**Land: 48.56 ha (119.85 ac)**

Internal Living: 124 sqm  
External Living: 162 sqm (terraces x3)  
Total: 286 sqm (carport & store not inc.)

- 1** Carport, 8.5m x 8.5m
- 2** Entry / Kitchen Terrace, 6.2m x 4.8m
- 3** Kitchen / Dining, 7.6m x 4.6m
- 4** Living / 10 Swag Courtyard, 13.8m x 7.9m
- 5** Living / Bedroom 1 (Guest), 5.7m x 3.6m
- 6** Laundry, 1.7m x 3.3m

- 7** Wet Room, 2.8m x 3.8m
- 8** Bath Terrace, 3.9m x 4.4m/6.1m
- 9** Bedroom 2, 4.3m x 3.8m
- 10** Study, 4.1m x 4.4m
- 11** Bedroom 3, 4.3m x 3.8m
- 12** Plant Room & Store, 8.5m x 1.6m